

CELL SPECIFICATIONS

Capacity	Typical	1800 mAh
	Minimum	1750 mAh
Cell Voltage	Nominal	3.7 V
	Charge	4.2 V
	Discharge	3.0 V
Charge Current	Standard	1.8 A
	Maximum	1.8 A
Charge Time	Standard	2.5 hr
Discharge Current	Maximum*	3.6 A
Internal Resistance	AC (1 KHz)	75 mΩ (Max)
Ambient Temperature	Charge	0°C to 45°C
	Discharge	-20°C to 60°C
Energy Density	Gravimetric	148 Wh/kg
	Volumetric	384 Wh/l

* Cycle life performance is not warranted at maximum discharge current.

PHYSICAL CHARACTERISTICS

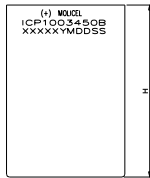
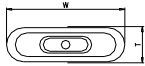

Shape	Prismatic
Can	Steel
Dimension	
Thickness (T)	*10.8 mm (Max) **11.0 mm (Max)
Width (W)	33.9 mm (Max)
Height (H)	49.4 mm (Max)
Weight	46 g (Max)
	*Thickness at shipping state
	**Thickness after 300 cycles

The information contained herein is for reference only and does not imply a performance guarantee or a product warranty. Specifications and characteristics are subject to change without prior notice. For application specific information, please contact E-One Moli Energy Sales and Applications or the nearest MOLICEL® recognized agent.

Charge Characteristics

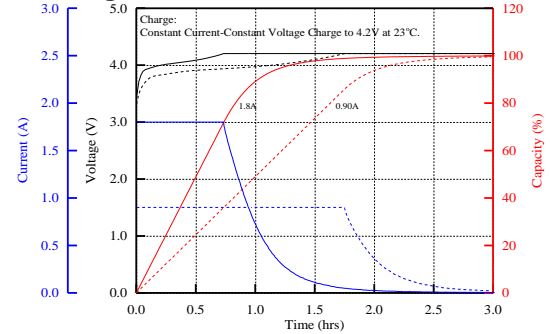

Discharge Rate Characteristics

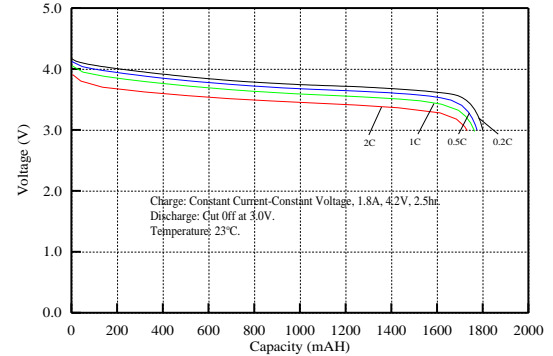

Discharge Temperature Characteristic

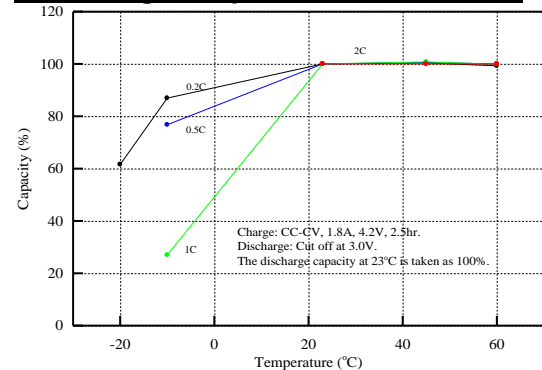

Cycle Characteristics

